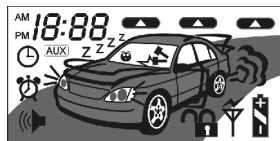

TABLE OF BUTTONS CONFIGURATION



Icons	Icon Descriptions
	Indication of no Acknowledgement
	Door Locked (Car Armed)
	Door Unlocked (Car Disarmed)
	Trunk Released
	Triggered by Shock Sensor
	Door Opened
	Ignition On or Triggered by Illegal Start
	Hood Opened
	Triggered by Microwave Sensor
	Car Light Flashing
	Keypad is Locked
	Sound Arming
	Silent Arming
	RTC (Real-time Clock)
	RTC Mode
	PAC (Personal Alarm Call) Mode
	Battery Life Indicator
	Auxiliary Output
	The System is in Arming Mode
	The Engine is in Short-Run/Turbo Mode
	The LCD Back Light is Enable

Button	Time pressed then release	Function	Condition	
	0.5 sec	Arm and Lock	Non-driving	
	2.0sec	Panic Mode		
	0.5 sec	Disarm and Unlock		
	2.0sec	Trunk Release		
	0.5 sec	Remote Query		
	2.0sec	Auxiliary Channel 5 Output	Non-driving, Armed	
	0.5 sec	Remote Start Timer Mode		
	0.5 sec	Remote Start ON/OFF		
	0.5 sec	Lock	Driving	
	2.0sec	Anti-robbery		
	0.5 sec	Unlock		
	0.5 sec	Turbo Mode		
	2.0sec	To Activate Set-up Menu		Any time
	0.5 sec	Keylock ON/OFF		
	0.5 sec	Hours or Minutes Increment		Correction of Real-time Clock or Time Set-up for Personal Alarm
	2.0sec	Hours or Minutes Increase Continuously		
	0.5 sec	Function Select		Menu Activated
	0.5 sec	Function Cancel		
	0.5 sec	Function Shift		

Note: "+" means press the buttons in sequence within 2 seconds.

WARRANTY

LIMITED WARRANTY

This Alarm & Starter product is warranted against manufacturing defects in material and workmanship for 360 days from the date of purchase from the authorized Dealer.

During the period, the Dealer will repair the products without charging the parts and labor cost.

The warranty does not cover damage or failure caused by or attributed to Act of God, abuse, misuse, improper or abnormal usage, improper maintenance, lightning or other incidence of excess voltage, or any repairs other than those provided by the Dealer's engineer and their facility.

When warranted time is expired, Dealer will repair the products only charging the parts cost.

Purchase Information

Name of Dealer _____

Address _____

Zip Code _____

Phone _____ Fax _____

Date of Purchase _____

Signature of Installation Engineer _____

Product Information

Model _____

Type of Vehicle _____

Serial number of Remote Control #1 _____

Serial number of Remote Control #2 _____

(1) How do I program the tach wire on the remote start systems?

It is not necessary. Our tach wires are self-learning for all remote start systems.

(2) To verify the tach signal:

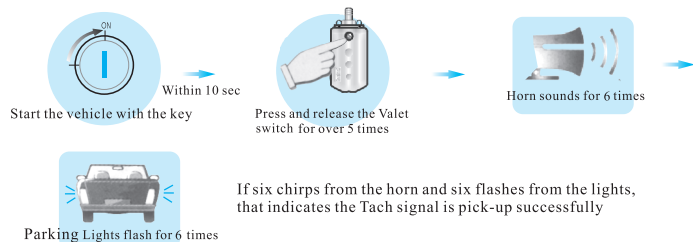

(3) Why will the vehicle not shut off when the brake is pressed?

All of the vehicle's doors must be shut for this work.

(4) Why does the vehicle keep attempting to restart itself when the remote start is armed?

You will need to try to relocate the purple with white trace wire on the remote starter module to find a stronger signal. Examples include sensing the oil sensor signal or generator signal if tach wire is not easy to locate.

(5) How do I make the remote starter turn on?

Push the "*" button for 1 second, let it go, and then push the "🔓" unlock button for 1 second, then let it go. All doors must be closed for the remote start to work.

Standard Arming Mode

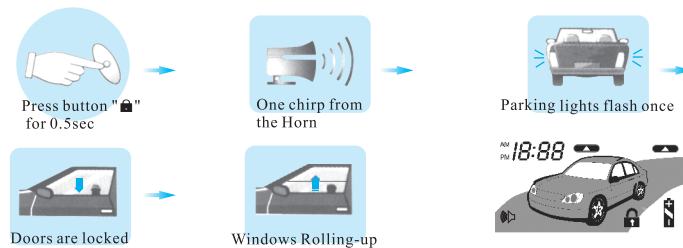

If you hear three more chirps after arming, maybe you need to re-check the doors to see whether they are properly closed. This chirp is called door zone bypass notification. This notification is given out when some door is not closed properly or if your car has a dome light delay. After the notification, the system will delay to monitor the door zone for an additional 20 seconds or until the dome light turns off.

The system also can remind you of arming the system if you forgot to do so. The system will give out three siren chirps with light flashes 20 seconds after you turn off the ignition key and close all the doors. After hearing the audible reminder, you should press button "🔒" to arm and lock.

If you select to install a Field Disturbance Sensor, such as a microwave sensor, the system can react to any intrusions into the field with the full triggered sequence.

Note: This system supplies a windows rolling-up feature. A windows rolling-up module may be necessary.

When Alarm is Triggered (In Arming State)

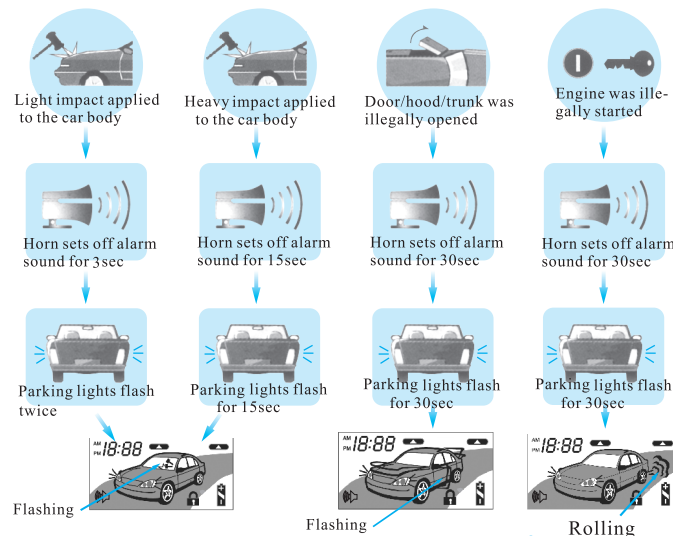

Notes:

- a: When alarm was triggered, engine was immobilized automatically.
- b: To shut off the alarm sound from the vehicle, press button "🔒" and the vehicle is still in the arming state.
- c: When the Remote Control successfully received the triggered alarming status ,it sets off warning beeps every 20 seconds. To release the warning beeping , press any button of the Remote Control.
- d: You may select an optional field disturbance sensor such as microwave sensor or radar sensor, your system can react to any intrusions into this field with the full triggered sequence.

Silent Arming Mode

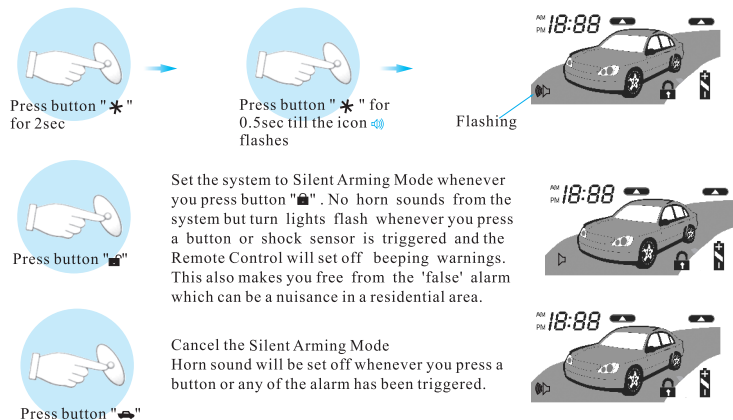

Multi-Level Security Arming

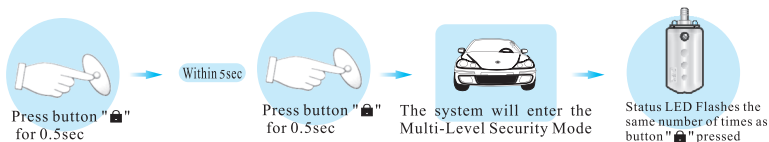

Multi-Level Security Arming allow you to select which of the system's inputs or sensors will be active and which will be bypassed when the system is armed. Each time Button "🔒" is pressed again, a different security level is selected. The different security levels are selected as follows:

Checklist of Options

FEATURES#	Option 1(default by button 🔒)	Option 2 by button 🔒	Option 3 by button 🚗
1.Power motor/Vacuum door locking system	Power motor (0.8s pulse)	Vacuum (3.5s pulse)	
2.Single/double pulse unlock	Single	Double	
3.Automatic rearming	ON	OFF	
4.Auto door lock/unlock when ignition is on	ON	OFF	
5.Parking lights flash when door opened in disarm mode	ON	OFF	
6.Passive Arming	OFF	ON	
7.Passive locking in passive arming mode	OFF	ON	
8.Auxiliary Channel 5 Output	0.8 second pulse	15seconds pulse	Latched output
9.Disarm when trunk release	OFF	ON	
10.Parking Lights Flashing/Constant	Flashing	Constant	
11.Gasoline/Diesel Engine Start	Gasoline	Diesel	
12. Crank Time Selection 1	1.2S(default)	0.9S	1.5S
13.Engine Run time	15 min	25 min	
14.Short Run/Turbo	1 min	2 min	3 min
15 Interval of timer start	3hour	2 hour	1hour
16 Anti-rob ignition kill	OFF	ON	
17 Dome light delay duration	12s	35s	
18 Crank Time Selection 2	1.8S	2.0S	2.5S

Program Features

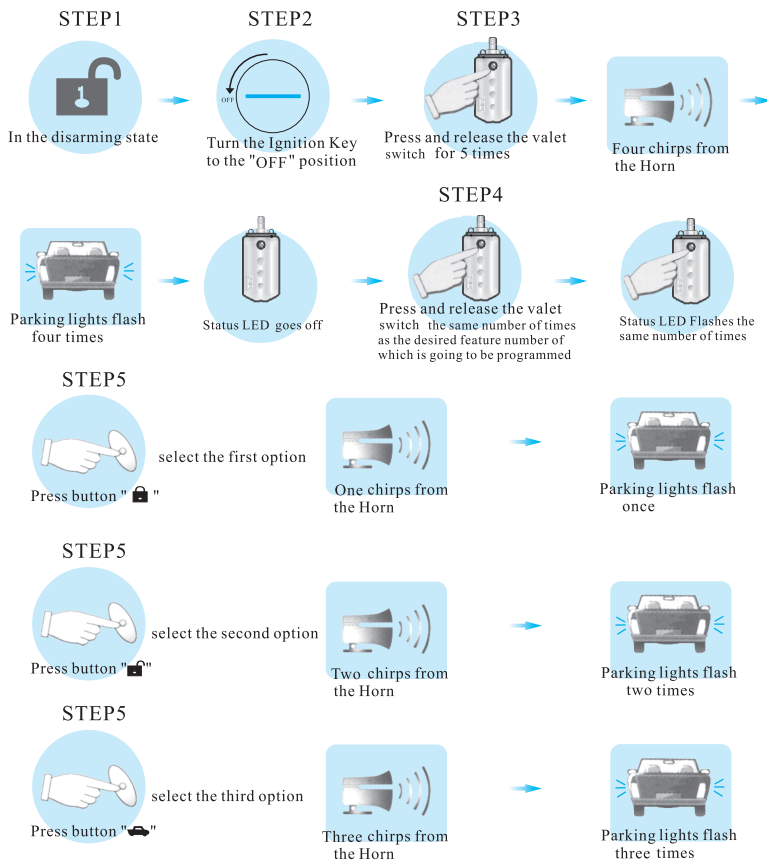

Note: Repeat step4 and step5 for each feature to be changed. If no programming activity occurs within a 10 second period, the Features Programming Mode will expire.

1. Press Button 🗄 once: The siren chirps once. The system is armed. All zones are active. LED indicator blinks once and then pauses for 2.0 seconds and then repeats.
2. Press Button 🗄 a second time within 5 seconds: The siren chirps once again. The shock sensor zone is now bypassed. LED indicator blinks twice with a two-second pause and then repeats.
3. Press Button 🗄 a third time within 5 seconds: The siren chirps one more time. The Optional sensor zone (Microwave sensor zone) is now bypassed. LED indicator blinks three times with a two-second pause and then repeats.
4. Press Button 🗄 a fourth time within 5 seconds: The siren chirps one more time. The Shock sensor zone and Microwave sensor zone are now bypassed. LED indicator blinks four times with a two-second pause and then repeats.
5. Press Button 🗄 a fifth time within 5 seconds: The siren chirps one more time. The Shock sensor zone, Microwave sensor zone, Hood Pin Switch input and trunk pin switch input are now bypassed. LED indicator blinks five times with a two-second pause and then repeats.

Note: Multi-Level Security Arming only applies to a single arming cycle. Once the system is disarmed and then re-armed, all the zones (inputs) will be active again.

Disarming

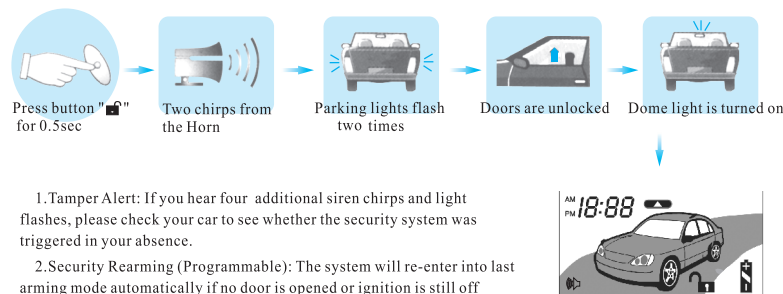

1. Tamper Alert: If you hear four additional siren chirps and light flashes, please check your car to see whether the security system was triggered in your absence.

2. Security Rearming (Programmable): The system will re-enter into last arming mode automatically if no door is opened or ignition is still off within 35s after disarmed by remote. This feature is to protect your car from theft even when your car is disarmed by accident.

3. Central Lock Automation (Programmable): This function enables your vehicle to automatically lock the doors upon pressing brake pedal after ignition is on and unlock the doors upon key off. During driving, you may also press button A to lock or button B to unlock without activating security mode.

4. Automatic Dome Light: The system will turn on the dome light every time you disarm your system. The dome light will go out 30 seconds later or immediately go out after you turn the ignition on.

5. Passive Arming and Passive Locking: The system also can be programmed to arm itself automatically (call passive arming). Once passive arming is enable, the system will arm itself in 40 seconds every time after the system "sees" you turn ignition off and leave your car by opening and closing the doors. If passive locking function is enable, the system will lock doors at the same time when entering passive arming.



Status Indicator goes out

FEATURES DESCRIPTION

Query Function

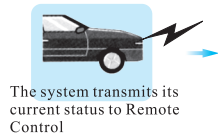

Panic Mode

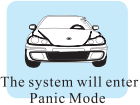

To stop Panic Mode at any time, press button 🚪 for 2.0sec again or press button 🔒 for 0.5sec.

Trunk Release

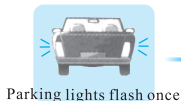

You may select whether disarm and unlock doors when trunk released by feature #9 of page 21 (trunk release function is suitable for cars with electric trunk opener)

Auxiliary Output (Programmable)

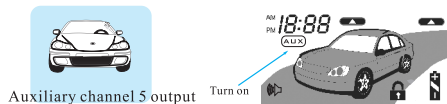

Auxiliary channel 5 output is programmed to output pulse of 0.5 seconds, 15 seconds or latched signal, reset with ignition.

SYSTEM INSTALLATION

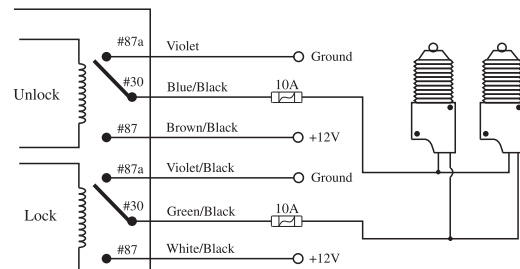

Adding Actuators

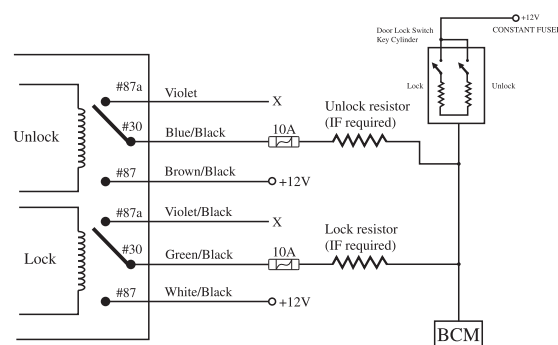

Positive Multiplex

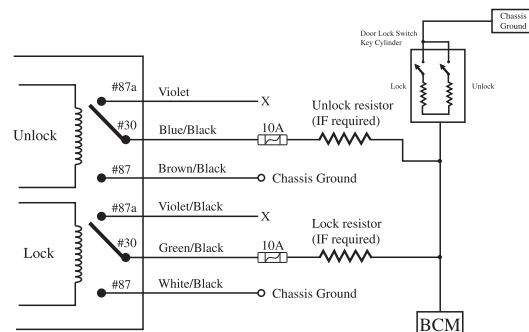

Negative Multiplex

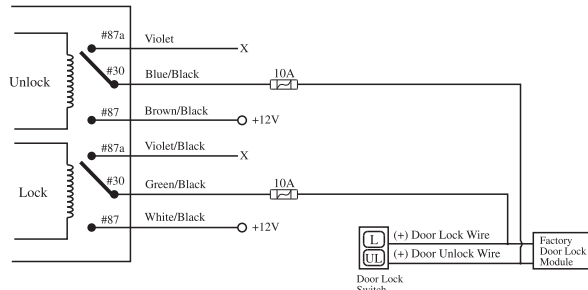

Positive Triggered, Relay-Driver System

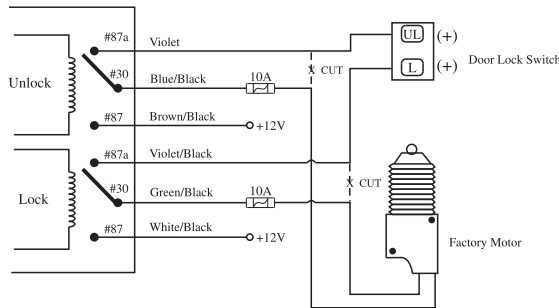

Reverse Polarity

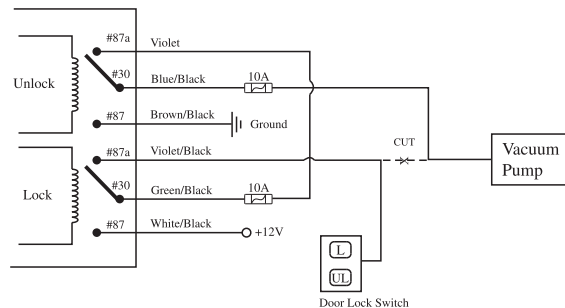

Vacuum Type

Remote Engine Start (Must Need Remote Start Module)

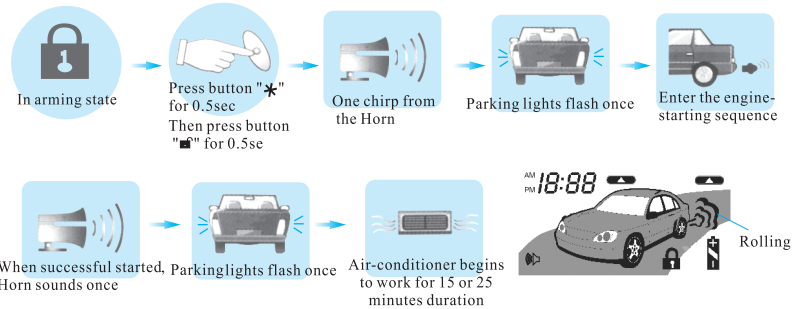

Note: 1. The parking lights will flash every 30 seconds during the engine is running
2. Never start the vehicle if it is not in either PARK or NEUTRAL position and never forget to activate the parking brake before remote start.
3. In gasoline vehicles, the engine will wait 6 seconds to start after the parking lights flash. In diesel vehicles, the engine will start when the WAIT-TO-START indicator on the vehicle's dash goes out.
4. It is unsafe to remote start the vehicle in a garage or other enclosed area. Breathing the exhaust from the vehicle is hazardous to your health.
5. For manual transmission vehicles, only when you've been setting the reservation mode, you can start your vehicle.

How to Drive Your Remote Started Vehicle:

- 1) Press button ■ 0.5s to unlock and disarm and open the door.
- 2) Insert the ignition key and turn it to the ON (not the START) position in 30 seconds.
- 3) Press the brake pedal.

Note: If the brake pedal is pressed before the key is in the ON position, the engine will shut down.

Remote shut down:

While the vehicle is running during remote start operation, the system will monitor the vehicle and will automatically shut down the engine if the system receives any of the following shut-down inputs:

- 1) The brake pedal is pressed.
- 2) The hood is opened.
- 3) The pre-programmed run time (15 or 25 minutes) has elapsed.
- 4) Press button * and button ■ again.
- 5) The TACH or Oil sensor or High voltage signal disappear.

The system senses the neutral transmission gear position automatically and there is no prior set-up required if cutting the loop wire at rear part of the main control unit.

The system in the standard transmission vehicle operates as following process when you exit the vehicle to sense and memorize the neutral transmission gear position. If the vehicle are of automatic transmission gear, this process is omitted.

1. Even if you pull off the Ignition key from the key cylinder after driving, engine continues running for further 1 minute from the time of pulling off the Ignition key.
2. Exit from the vehicle within 1 min. after pulling off the Ignition key. The engine still continues running and it is normal operating process.
3. Open the doors and close the doors, the engine shuts down immediately and the system sets off a beep sound with a light flash to indicate that engine start memorizing is successful.
4. Press button  to lock the doors and the system is now ready for next remote engine start.

If the doors are opened after above process, the prior memorization for the next remote start sequence is deleted and the function shall not work until you repeat above process again.

To cancel above prior memorization process for remote engine start sequence.

(A).Method 1

Pull off the Ignition key while the driver's side door is opened and the Dome Light stays turned on. Then, the engine shall be shut down immediately and prior-memorization for the next engine start is cancelled.

(B).Method 2

Pull off Ignition key while stepping the brake pedal, doors are unlocked and then, the engine shall be shut down immediately and prior-memorization for the next engine start is cancelled

Pin 4: GREY WIRE: Hood Pin Input (-). Connect this wire to the hood pin switch. The switch must supply a ground output(-)when switch is opened. This input will disable or shut down the remote start when the hood is opened. It will also trigger the security system if the hood is opened while the system is armed.

Pin 5: BROWN WIRE: Brake Input (+). Connect to the wire that shows +12V when pressing the brake. The brown wire is a safety shutdown wire that must be connected.

Pin 6: YELLOW WIRE: (+) Ignition Input of the Key Cylinder to Alarm. Connect to the ignition wire that provides +12V when the ignition is on and while cranking the starter.

Pin 7: GREEN WIRE: Negative Door Input (-). Most vehicles use negative door trigger circuit. Connect the green wire to the wire that shows ground when any door is opened. In vehicles with factory delays on the dome-light circuit, there is usually a wire that is unaffected by the delay circuit.

Pin 8: PURPLE WIRE: Positive Door Input (+). Connect to the door switch circuit wire that shows +12V when any door is opened. This type of door circuit is usually found on Ford Vehicle.

Peripheral Plug-in Connectors

7-PIN White Connector: Two-way Transceiver Communication Port

3-PIN Black Connector: Optional Sensor Input port, for example, the Microwave Sensor.

2-PIN White Connector: LED Port. Mount LED in an area where it may be easily seen from either side of the vehicle.

Door Lock Wiring Diagram

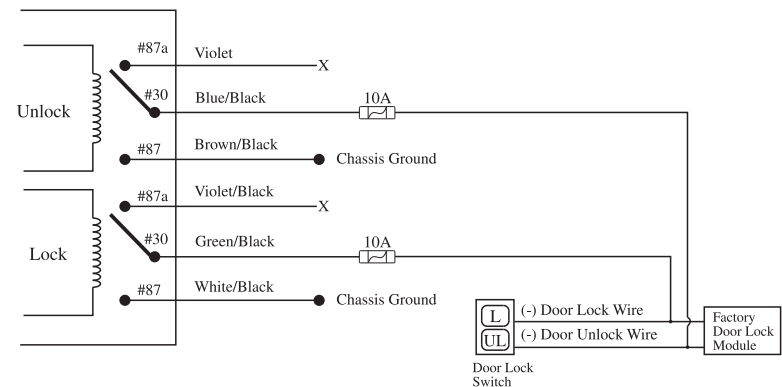

Negative Triggered, Relay-Driver System

Pin4: Blue/Black: Unlock #30 Common (Output)

Pin5: Brown/Black: Unlock #87 Normally Open (Input)

Pin6: Violet/Black: Lock #87a Normally Closed

Pin7: Green/Black: Lock #30 Common (Output)

Pin8: White/Black: Lock #87 Normally Open (Input)

Pin9: Red: Constant +12V Input. Connect this wire to the battery or Constant Power wire at the Ignition Switch with a 15Amp Supply.



Pin10: Black: System Ground. Connect this wire firmly to the Chassis Ground.

6-pin Secondary Harness for Outputs(H2)

Pin 1: ORANGE WIRE: Armed Output (-) 500mA. The orange wire supplies a ground output while armed to activate a relay for starter defeat and anti-grind protection.

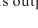
Pin 2: BLUE WIRE: Second unlock (passenger unlock) output (-) 200mA This system is equipped with a dedicated passenger unlock output allowing two stage door lock operation. When connected this wire, disarming the system will unlock only the driver's door. Pressing the disarm button again will unlock all doors..

Pin 3: WHITE/BLACK WIRE: Auxiliary Channel 5 Output (-) 200mA. This wire provides a (-) 200mA output whenever the transmitter button  is pressed for 2S. This output can be programmed to provide the following types of outputs:

- a. 0.8-second timed: Output that will send a ground pulse of 0.8 second.
- b. 1.5-second timed: Output that will send a ground continuous pulse for 15 seconds.
- c. Latched, reset with ignition: Output that will send a signal when the Channel 5 button (button ) is pressed and will continue until the same button (button ) is pressed again. It additionally stops output whenever the ignition is turned on.

Pin 4: PURPLE/BLACK WIRE: Auxiliary 4 Output (-) 500mA for windows rolling-up option. Connect to a power window module.

Pin 5: BLACK/WHITE WIRE: Dome Light Output (-) 500mA. Connect to the wire that activate the vehicle's dome light, usually the door pin switch wire. Note: the dome light output can usually connect to the same wire used for the door trigger input (see purple and green door input wire).

Note: This output is only intended to drive a relay. It can not be connected directly to the dome light circuit, as the output cannot support the current draw of one or more light bulbs. Never use this wire to drive anything but a relay or a low-current input. The transistorized output can only supply 200mA of current. Connecting directly to a solenoid, motor, or other high-current device will cause it to fail.

Pin 6: RED/WHITE WIRE: Vehicle Trunk Release Wire (-) 500mA. Connect this wire to the electronic trunk opener. (Relay may required).

8-pin 2510 Harness for Inputs and Outputs(H3)

Pin 1: GREEN/BLACK WIRE: Factory Disarm Output (-) 500mA. This wire provides a ground output on disarming and before remote starting to disarm a factory security system. Connect to the wire that requires a ground pulse to disarm the factory security system.

Pin 2: GREEN/WHITE WIRE: Factory Rearm Output (-) 500mA. This wire supplies a ground output on remote start shutdown to rearm a factory security system. Connect to the wire that requires a ground pulse to rearm the factory security system.

Pin 3: RED WIRE: (+) Locate the wire which is usually connected to the Oil Sensor on the dashboard or to the alternator in the engine compartment and connect this wire. 2-3V shows on the multimeter when the ignition key is turned to second turn position in the key cylinder and +12V/+14V shows when the starter motor is running.

Turbo/Short Run

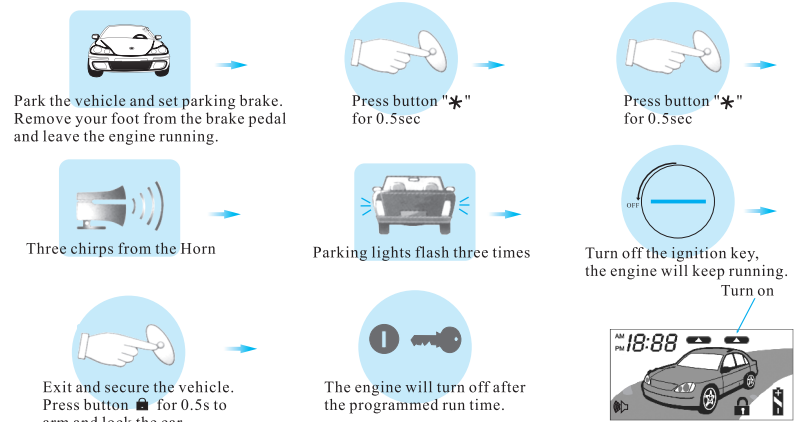

Note: Once you activate the short-run turbo mode, the system will remain in this mode always. If you don't want this mode anymore, press button * * again to cancel it anytime.

Remote Start Timer Mode

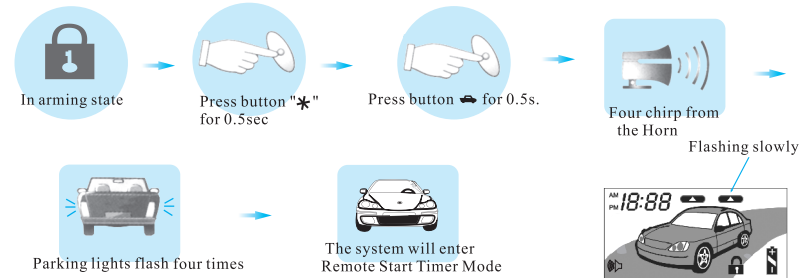

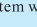
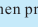
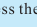
1. In this mode, the system will start the engine every 3, 2 or 1 hours by options, for a maximum of six cycles. The engine will run for the programmed run time and then shut down to keep engine warm in the cold weather.
2. The remote start command * +  can shut down the engine in timer mode, but the system will remain in the timer mode.
3. To exit timer mode, press button  0.5s to disarm the system, turn the ignition key on and then press the brake pedal or press button * 0.5s and then button  0.5s again.
4. If any other shut down zones or alarm has been triggered, the timer mode will cancel.

Valet Mode

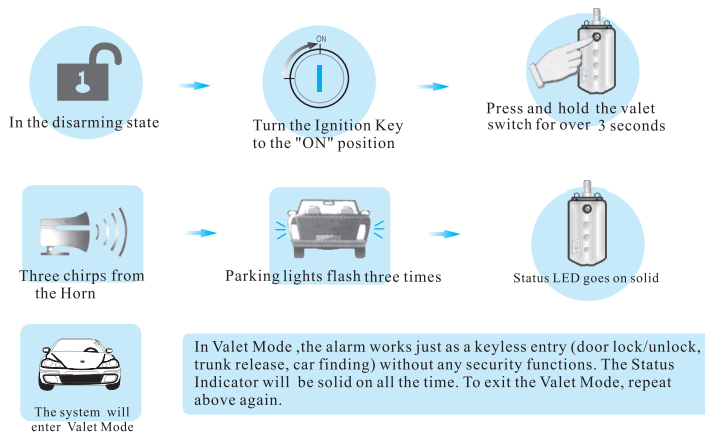

Correction of Real-time Clock

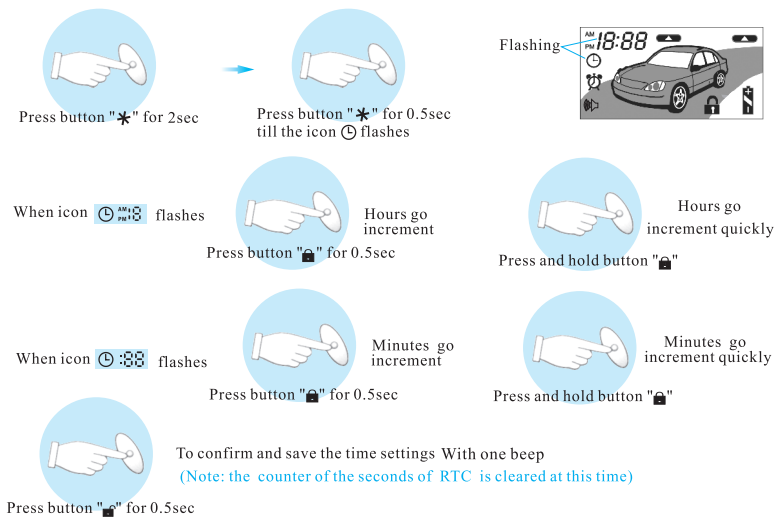

Harness Description

5 Heavy Gauge Starter Harness in the Starter Module (Ignition Switch Interface)

Purple Wire: Starter Output (+). Connect to the vehicle's starter wire.

ORANGE WIRE: Accessory Output (+). Connect to the accessory wire coming from the ignition switch that supplies power to the heater/air-conditioner. Some cars may have multiple accessory wires.

PINK WIRE A: Ignition Output (+). Connect to the main ignition wire that provides +12V when the ignition is on and while cranking the starter.

PINK WIRE B: Second Ignition Output (+). Connect to the second ignition wire of the vehicle.

RED WIRE: Main Power Input (+). Connect to the battery or constant power wire at the ignition switch with a minimum 30 Amp supply. **Remove the fuse until the installation is completed and all wiring is checked.**

7-pin Connector Secondary Harness for Remote Start(H4)

Pin1-3: Factory wiring to the remote start module.

Pin4: BLUE/WHITE WIRE: (-)200ma bypass output when remote start. Connect this wire to the interface of Remote Start Bypass Module.

Pin 5: GREY/ BLACK WIRE: Diesel wait-to-start bulb input. (+) Connect this wire to the wire in the vehicle that sends the signal to turn on the WAIT-TO-START bulb in the dashboard. In most diesels, the wire is negative (ground turns on the bulb) and the GRAY/BLACK wire can be directly connected to the wire in the vehicle. If the vehicle uses a positive wire (12V to turn on the bulb), you may add external relay to change the polarity.

Pin 6: BLACK/WHITE WIRE: (-)Neutral Safety Switch Input. Connect this wire to the PARK/NEUTRAL switch in the vehicle. This wire will test with ground with the gear selector either in PARK or NEUTRAL. This will prevent the vehicle from accidentally being started while in a drive gear. This input MUST rest at ground in order for the remote start system to operate. Connected properly the vehicle will only start while in PARK or NEUTRAL. You may also connect this wire to the Parking Brake Switch.

Pin 7: VIOLET/WHITE WIRE: Tachometer Input/Constant power Input (Optional)wire. This input provides the module with information about the engine's resolution per minute (RPMs). Connect to the vehicle's tach wire. Common locations for a tachometer wire are the ignition coil, instrument cluster, fuel injectors, or engine computers. The correct wire shows between 1V to 6V (AC) and fluctuates with the idle of the engine when testing with a multi-meter capable of testing AC voltage.

Note: This wire has the same function with the Constant power sensing input, so it is an alternative solution when Tachometer input does not supply satisfactory operation. If connect to the Constant power sensing input, It is a easy way to sense if remote start has been successful(Tachless Method).

10-Pin Connector Primary Harness (H1)

Pin 1: BROWN WIRE: Siren Output (+). The brown wire must connect to the red wire of the siren. The black wire must be grounded.

Pin 2: WHITE WIRE: Parking Light Output (+/-) Relay. Connect this wire to the circuit that shows +12V or ground only when the parking lights are on and set the internal parking light relay jumper to the proper polarity. For parking light circuits exceeding 10 Amps, a relay is required. For vehicles with independent left and right parking light circuits, diodes must be installed to keep the circuits separate.

Note: Do not connect the white wire to the vehicles headlight circuit.

Pin3: Violet: Unlock #87a Normally Closed

FEATURES DESCRIPTION

Anti-Robbery

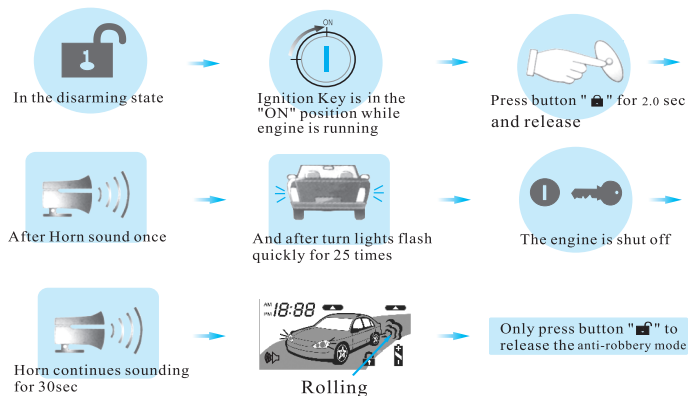

NOTE: If set the feature #16 of page 21 to option 1, the engine will not be shut-off, but horn keeps sounding and turn lights keep flashing for 30s.

Back Light Illumination ON/OFF

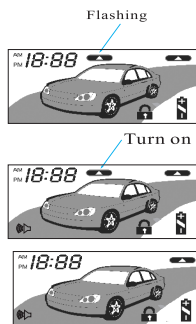

Disarm the System Without Remote Control

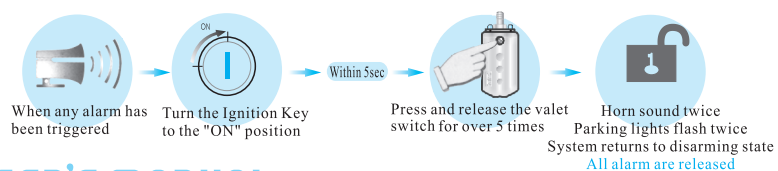

FEATURES DESCRIPTION

Time set-up for Personal Alarm

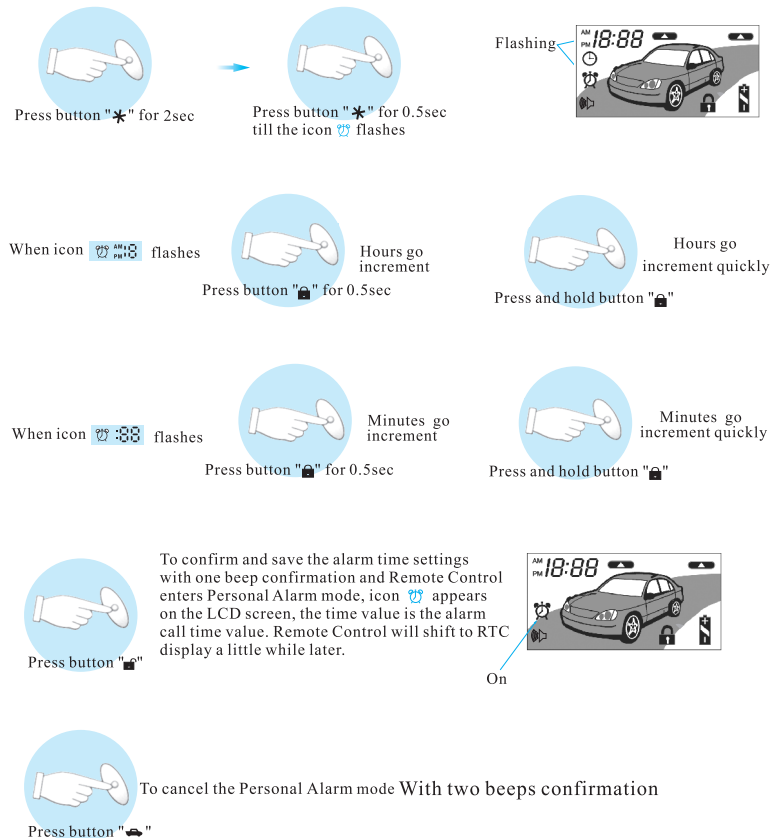

Note: Alarm keeping will be activated when time reaches the setting alarm time and Remote Control will remain in the Personal Alarm mode automatically. If you want to exit Personal Alarm mode, just press button "★" for 2sec and then press "★" for 0.5sec till the icon 🗓️ flashes, and press button "🔒" to cancel PAC Mode.

Code Memorizing of Remote Control

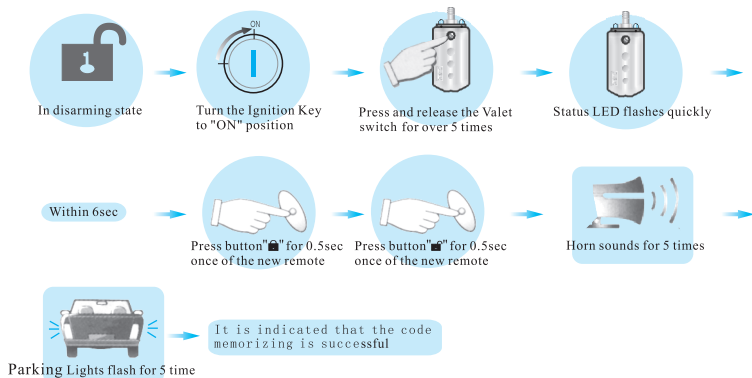

Note:

- a: The Remote Control's code has been memorized in the factory, you do not need to memorize it unless you lose the Remote Control and obtain a new one or you want to buy one more Remote.
- b: The system can memorize at most two Remote Controls.

Key Lock Function of Remote Control

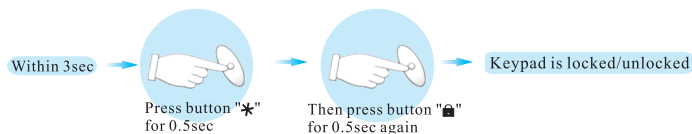
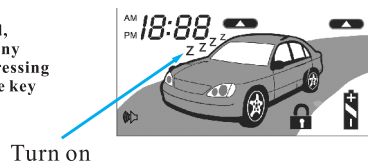

Figure shows the keypad is locked, when keypad is locked, pressing any key will not be activated unless pressing the * - 🔒 combination to cancel the key lock mode.



Turn on

Installation Adjustment for Shock Sensor

The shock sensor is built in the communication unit. You can adjust the shocking sensitivity by changing the position "H", "M", or "L" of the adjustment switch on the communication unit.

Door Status Warning (Programmable)

The lights will flash to inform you that some door is not closed well. When temperately parking, such flashing may warn coming cars to take care. It is suggested to cancel this feature when your car has a dome light delay.

Automatic Windows Rolling-up

This system supplies a windows rolling-up feature. The system will roll up all the windows at the arming command to ensure safety of your vehicle. (A windows rolling-up module may be necessary. Please contact your local dealer for details)

Status Memory

This system may remember the status before power off so as to restore the former working status such as arm mode, disarm mode and Valet mode, even if the power supply is destroyed.

Smart LED Indicator

In arming status: LED flashes the same number as the times of pressing button 🔒 within 5 seconds.

In turbo state: LED stays solid for 2 seconds, then pause for 2 seconds.

In valet mode: LED stays solid.

ACC, Door, Hood/Trunk triggered: LED stays solid for 0.5 seconds, then pause for 0.5 seconds.

High Frequency

Your system remote control and communication unit are produced by FM technology at 433Mhz. This provides a cleaner spectrum with less interference and a more stable signal. Enjoy a phenomenal increase in range, even in areas with high radio interference.

Code Hopping

This system uses code hopping technology to increase the security of the alarm. In case the remote falls out of sync with the main control unit, it will fail to operate the system. To re-sync the system, please remove the battery of the remote, wait for 10 seconds and re-power the remote again, and then press button 🔒, the alarm will automatically re-sync and respond to the remotes normally.